

## OVERALL PLAN

### DESIGN PROPOSAL

1. Kerb extension and kerb ramps to reduce crossing distances and increase pedestrian safety.
2. Relocate pedestrian crossing to improve access and increase on street parking.
3. Rain gardens to capture gutter flows draining towards Mitchell Street.
4. Potential occasional street closure for markets and community events.
5. Footpath widening outside library with seating and planting.
6. Speed cushion to increase pedestrian safety.
7. Planting of Golden Penda through main commercial centre to provide canopy shade and accentuate commercial centre.
8. New ashlar pattern footpath. Generally all footpaths have been widened.
9. Planting of Southern Mahogany within streetscape to provide canopy shade, biodiversity and vertical accent.
10. Planting of Broad Leaved Lilly Pilly to provide canopy and habitat while being resilient to trimming.
11. Footpath continuation across laneways to give pedestrians priority.

### NOTES:

1. A 40km zone with associated traffic calming devices is proposed for the Mitchell Street Upgrade. All existing car parking arrangements are retained unless shown on the plan

### CARPARK NUMBERS

	EXISTING	PROPOSED
CAR SPACES	59	55
DISABLED SPACES	1	2
BUS	4	4
LOADING	2	2

The new kerb extensions at intersections shortens available parking spaces. Only entire spaces are denoted in the table.

2. Street tree planting has been introduced to provide greening, shade, habitat and biodiversity within the streetscape.

### STREET TREES

NEW TREES PROPOSED	40
--------------------	----

3. This is a concept plan for the communication of proposals - not a detailed civil design. In some instances the final layout may vary to accommodate underground infrastructure and technical requirements.

### LEGEND

	Existing tree to be removed		New concrete ashlar footpath		Speed cushion to slow traffic
	Existing tree to be retained		New concrete footpath		Potential Outdoor Dining/Retail Space
	New tree: Southern Mahogany (Eucalyptus botryoides)		Decorative paving to indicate rain gardens		Food/Drink Outlet
	New tree: Broad Leaved Lilly Pilly (Acema hemilampra)		Proposed concrete kerb		Bus Stop
	New tree: Golden Penda (Xanthostemon chrysanthus)		Permeable kerb		
	Mass planting to rain garden		Bus stop		
	Mass planting		Accessible parking		
	Turf		Pedestrian crossing		



Southern Mahogany (Eucalyptus botryoides)



Rain gardens proposed to capture runoff



Street furniture drawn from skate hub



Concrete ashlar pavement to Mitchell Street

# Mitchell Street Upgrade

NOVEMBER 2020

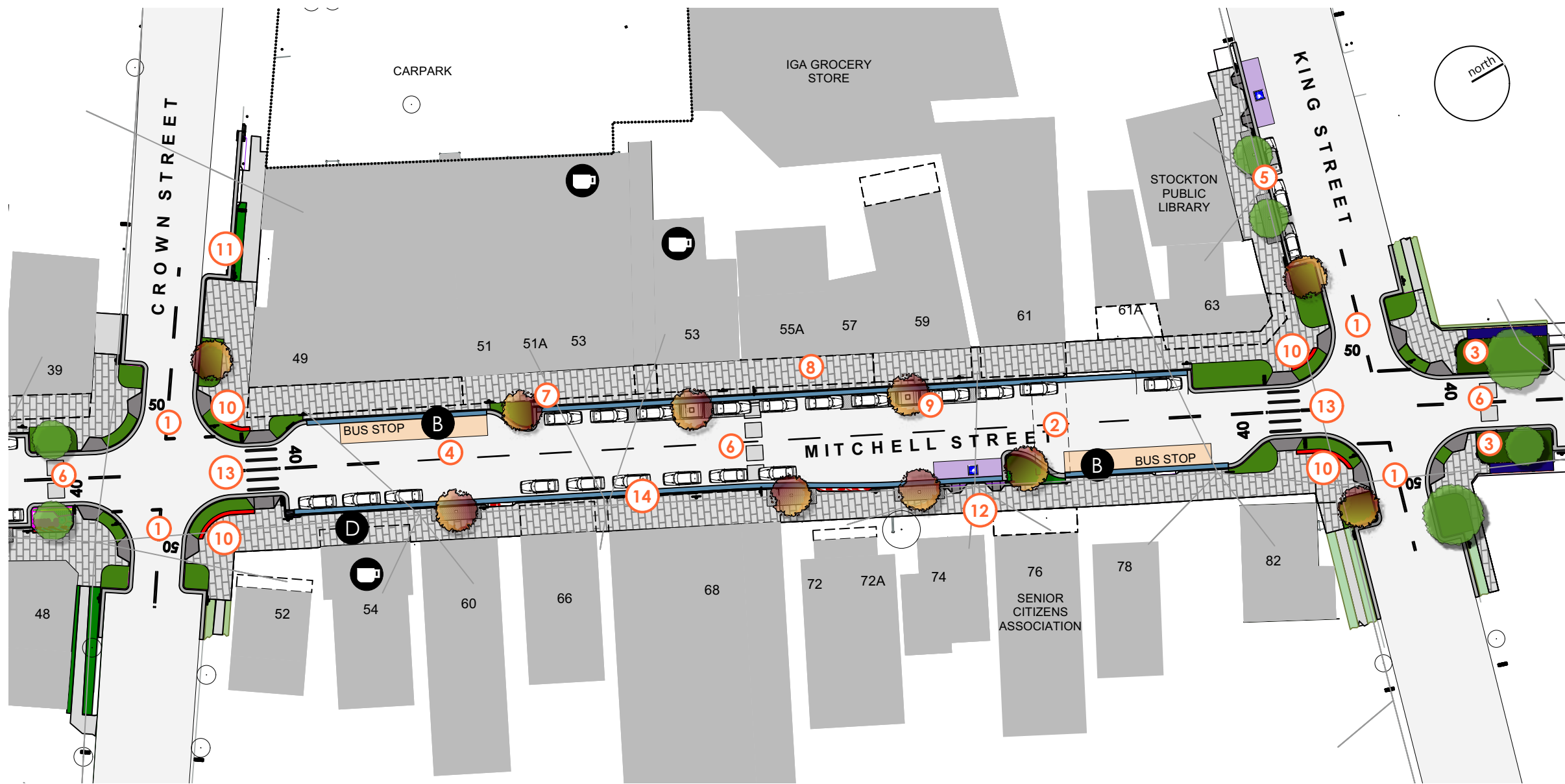

- LEGEND**
- Existing tree to be removed
  - Existing tree to be retained
  - New tree: Southern Mahogany (Eucalyptus botryoides)
  - New tree: Broad Leaved Lilly Pilly (Acmena hemilampra)
  - New tree: Golden Penda (Xanthostemon chrysanthus)
  - Mass planting to rain garden
  - Mass planting
  - Turf
  - New concrete ashlar footpath
  - New concrete footpath
  - Decorative paving to indicate rain gardens
  - Proposed concrete kerb
  - Permeable kerb
  - Bus stop
  - Accessible parking
  - Pedestrian crossing
  - Speed cushion to slow traffic
  - Potential Outdoor Dining/Retail Space
  - Food/Drink Outlet
  - Bus Stop

**DETAIL PLAN**

- DESIGN PROPOSAL**
1. Kerb extension and kerb ramps to reduce crossing distances and increase pedestrian safety.
  2. Relocate pedestrian crossing to improve access and increase on street parking.
  3. Rain gardens highlight in the streetscape with decorative patterning emphasising "water polishing" locations with tolerant grasses to help reduce surface runoff and improve water quality.
  4. Potential occasional street closure for markets and community events.
  5. Footpath widening outside library with seating, 1 hour timed parking and kerb ramps to improve accessibility.
  6. Speed cushion to increase pedestrian safety.
  7. Planting of Golden Penda through main commercial centre to provide canopy shade and accentuate commercial centre.
  8. New ashlar pattern footpath. Generally all footpaths have been widened.
  9. In road street tree planting provide shade and maintain low vehicle speeds.
  10. Commercial centre framed with stone seating walls.
  11. Decorative planting continued on adjoining streets where commercial buildings occur.
  12. Accessible parking space close to Doctor and Senior Citizens Centre.
  13. Kerb extension, pedestrian crossing and lighting upgrade.
  14. Permeable kerb installed to reduce runoff and improve water quality in low lying areas.

**MITCHELL STREET TYPICAL SECTION**

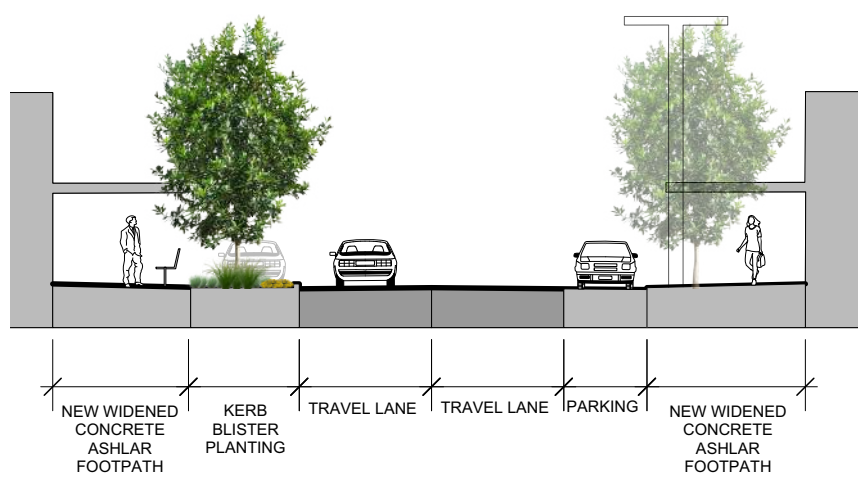

Golden Penda (Xanthostemon chrysanthus)



Blush Satinash (Acmena hemilampra)



Seating walls frame commercial centre

**Mitchell Street Upgrade**

NOVEMBER 2020

